



**HENDERSON
CONNELLAN**
ESTATE AGENTS

South Street, Isham NN14

"Set in Stone"

3 1 2



"Set in Stone"

This lovely stone, detached home is discreetly positioned in the heart of this desirable village. Isham has a very popular pub, primary school and Church, lovely rural walks as well as ultra convenient access to Kettering & Wellingborough along with their respective railways. The light filled interior has a modern touch with Oak interior doors to include a guest cloakroom, entrance porch leading to the dining room with working fire which opens to the living room with feature fireplace and bay window and the kitchen has a walk in pantry. Upstairs there is a principal bathroom and three double bedrooms, the master with built in wardrobes. Outside the wrap around gardens have a mature feel with a good degree of privacy, there is a private driveway, oversized single garage and a workshop which could be converted to create a great space for home working. A lovely home!

Living Room - 3.51m x 3.1m (11'6" x 10'2")

Dining Room - 4.06m x 3.33m (13'4" x 10'11")

Kitchen - 2.46m x 2.41m (8'1" x 7'11")

Pantry/ Utility Room - 1.83m x 1.42m (6'0" x 4'8")

WC - 1.65m x 0.91m (5'5" x 3'0")

Bedroom One - 4.06m x 3.3m (13'4" x 10'10")

Bedroom Three - 3.66m x 2.41m (12'0" x 7'11")

Bedroom Two - 3.1m x 3.05m (10'2" x 10'0")

Bathroom - 3.35m x 1.83m (11'0" x 6'0")



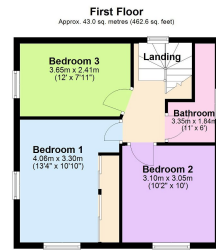
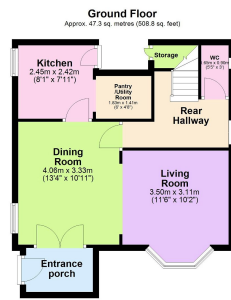

Total area: approx. 90.3 sq. metres (971.5 sq. feet)

- Detached Stone and Brick Built
- Cottage
- Three Bedrooms
- Village Location
- Two Reception Rooms
- Ground Floor WC
- Single Garage and Parking
- Gas Central Heating
- EPC RATING: PENDING
- COUNCIL TAX: E



15-16 Market Place, Kettering,
Northamptonshire, NN16 0AJ

Disclaimer: These particulars do not form part of any offer or contract and should not be relied upon as statements or representations of fact. Any areas, measurements of distances are approximate. The text, photographs and plans are for guidance only and are not necessarily comprehensive.

